

**1 VICINITY AND LOCATION MAP**

**NOT TO SCALE**

 <p><b>NATIONAL PARKS DEVELOPMENT COMMITTEE</b> TM KALAW MANILA</p>	PROJECT TITLE:	PREPARED BY:	RECOMMENDING APPROVAL:	APPROVED BY:	SHEET CONTENT	SHEET NO.
	INSTALLATION OF FIBER OPTIC IN RIZAL PARK AND PACO PARK PROJECT (AMENDMENT TO ORDER)	ENGR. LERIZA S. CANALES DRAFTSMAN II	ENGR. EDUARDO C. VILLALON JR. PLANNING OFFICER V	CECILLE LORENZANA ROMERO EXECUTIVE DIRECTOR III	SECURITY OFFICE(KWEB)	<b>AR-01</b>
	LOCATION: CENTRAL SECTION, RIZAL PARK, TM KALAW MANILA	CHECKED BY: KATHLEEN DC. MELENDREZ PLANNING OFFICER IV				

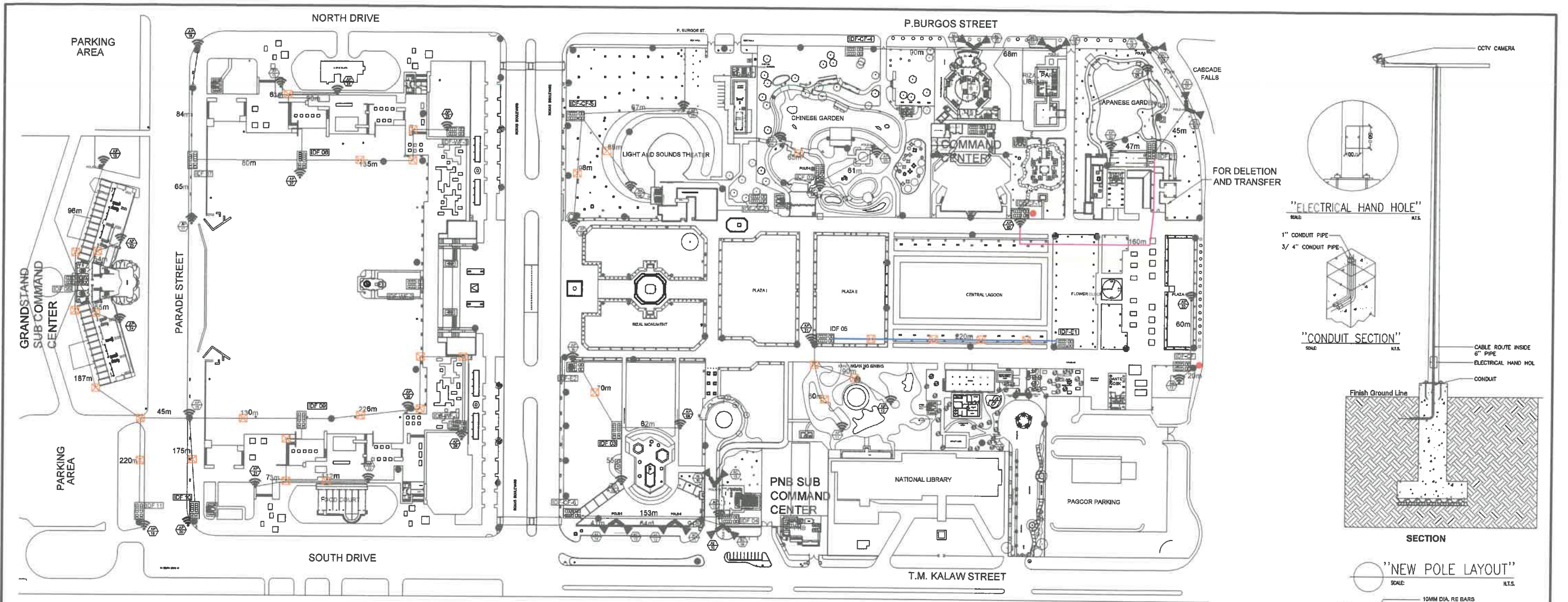



LEGEND	
	FOR DELETION/ TRANSFER OF FIBER OPTIC LINE
	ADDITIONAL FIBER OPTIC LINE
	FOR REVISION (DELETION/ADDITIONAL OR TRANSFER)
	PROPOSED HAND HOLE
	PROPOSED ADDITIONAL POLE

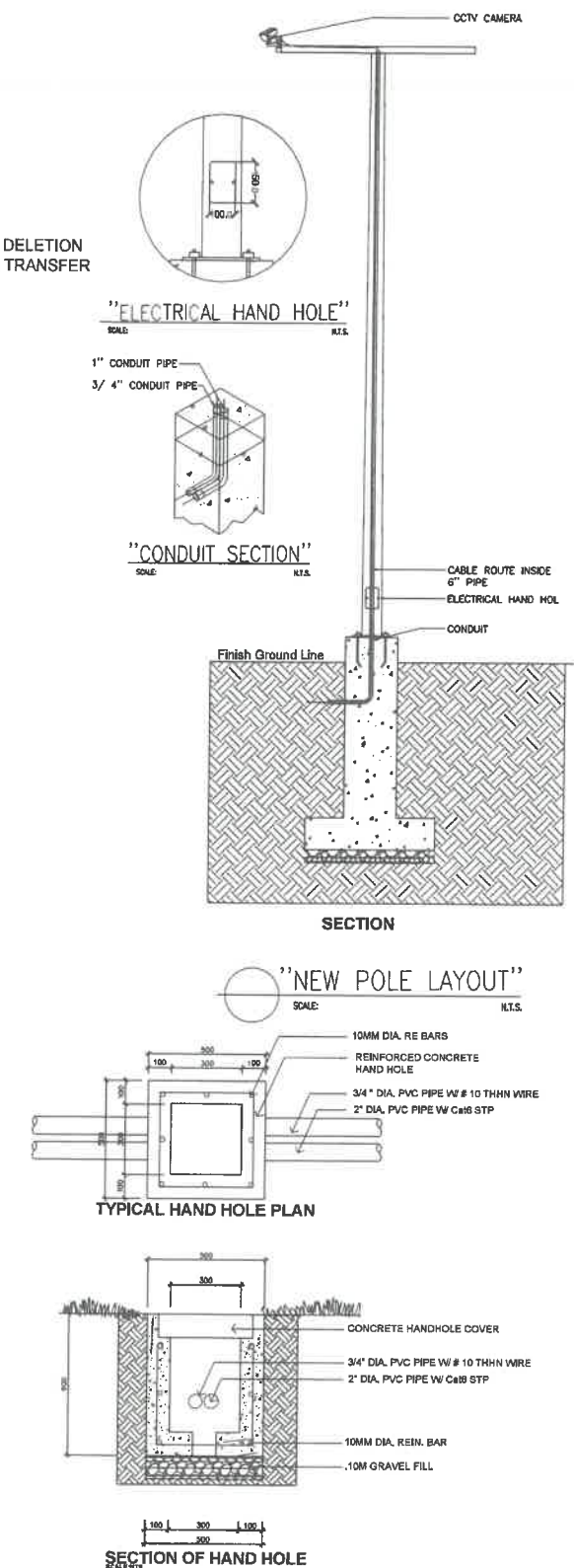

**1 FIBER OPTIC IN RIZAL PARK (AMENDMENT TO ORDER), POLE LAYOUT ND HAND HOLE LAYOUT**

**NOT TO SCALE**

<p><b>NATIONAL PARKS DEVELOPMENT COMMITTEE</b> TM KALAW MANILA</p>	PROJECT TITLE:	PREPARED BY:	RECOMMENDING APPROVAL:	APPROVED BY:	SHEET CONTENT	SHEET NO.
	INSTALLATION OF FIBER OPTIC IN RIZAL PARK AND PACO PARK PROJECT (AMENDMENT TO ORDER)	ENGR. LERZA S. CANALES DRAFTSMAN II	ENGR. EDUARDO C. VILLALON JR. PLANNING OFFICER V	CECILLE LORENZANA ROMERO EXECUTIVE DIRECTOR III	FIBER OPTIC IN RIZAL PARK (AMENDMENT TO ORDER)	<b>AR-02</b>
	LOCATION: CENTRAL SECTION, RIZAL PARK, TM KALAW MANILA	KATHLEEN DC. MELENDREZ PLANNING OFFICER IV				

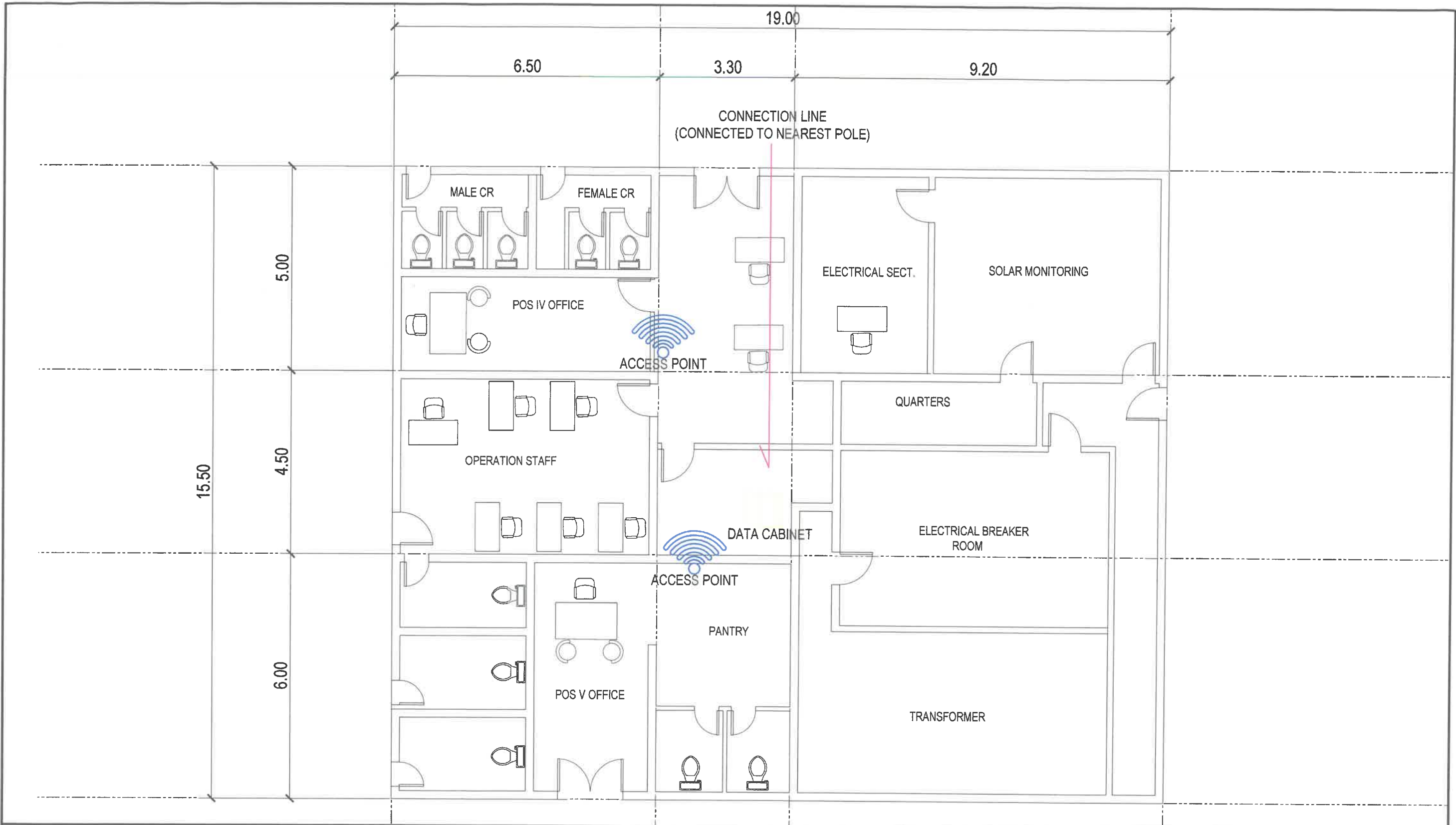





**1 SECURITY OFFICE (KWEBA)**

**SCALE: 1:100MTS**

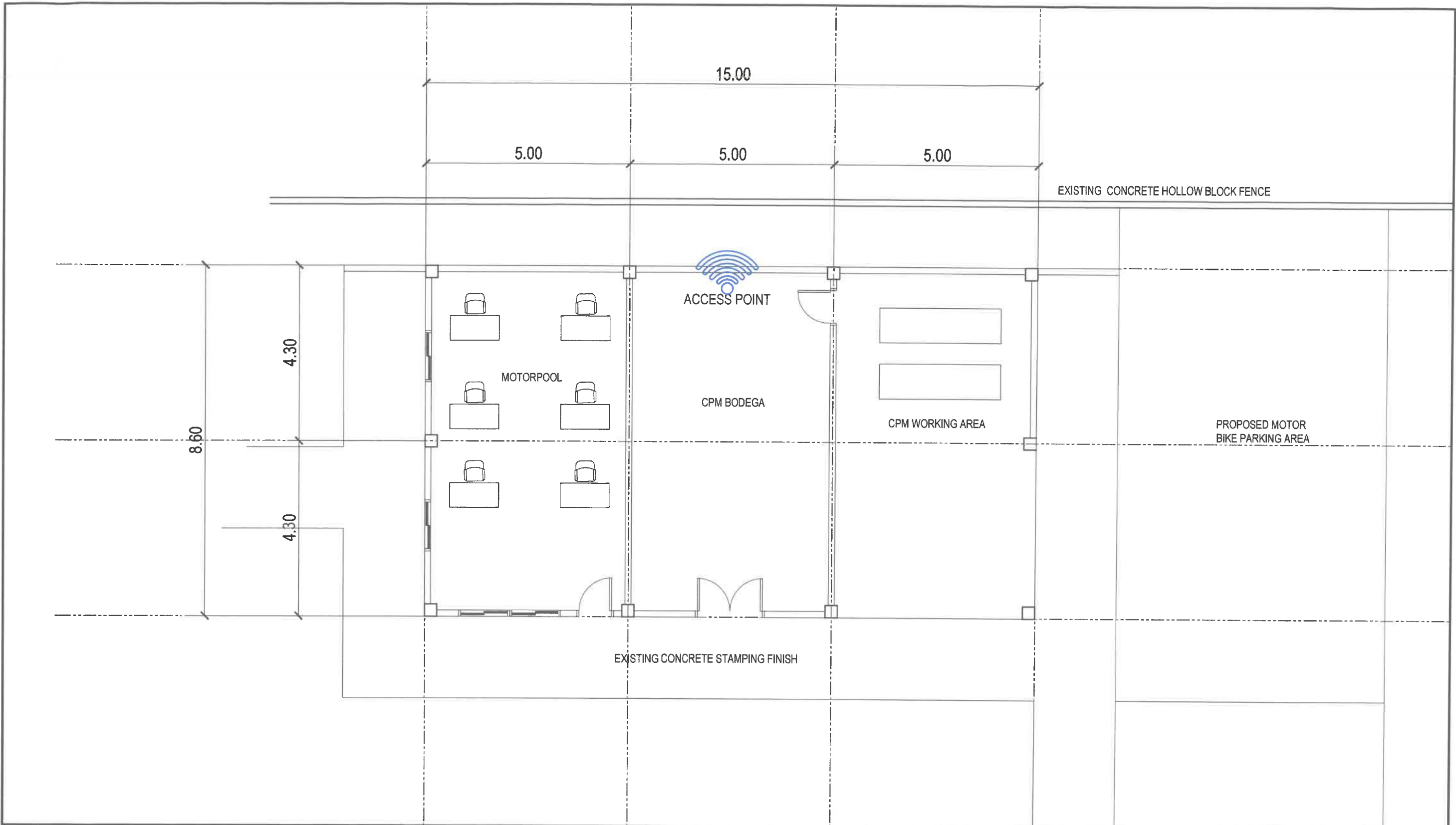
 <p><b>NATIONAL PARKS DEVELOPMENT COMMITTEE</b> TM KALAW MANILA</p>	PROJECT TITLE :	PREPARED BY:	RECOMMENDING APPROVAL:	APPROVED BY:	SHEET CONTENT	SHEET NO.
	INSTALLATION OF FIBER OPTIC IN RIZAL PARK AND PACO PARK PROJECT (AMENDMENT TO ORDER)	ENGR. LERIZA S. CANALES DRAFTSMAN II	ENGR. EDUARDO C. VILLALON JR. PLANNING OFFICER V	CECILLE LORENZANA ROMERO EXECUTIVE DIRECTOR III	SECURITY OFFICE(KWEBA)	<b>AR-03</b>
	LOCATION: CENTRAL SECTION, RIZAL PARK, TM KALAW MANILA	CHECKED BY: KATHLEEN DC. MELENDREZ PLANNING OFFICER IV				





<b>2 CPM (KWEBA)</b>						<b>SCALE: 1:100MTS</b>
 <p><b>NATIONAL PARKS DEVELOPMENT COMMITTEE</b> TM KALAW MANILA</p>	PROJECT TITLE :	PREPARED BY:	RECOMMENDING APPROVAL:	APPROVED BY:	SHEET CONTENT	SHEET NO.
	INSTALLATION OF FIBER OPTIC IN RIZAL PARK AND PACO PARK PROJECT (AMENDMENT TO ORDER)	<b>ENGR. LERIZA S. CANALES</b> DRAFTSMAN II CHECKED BY: <b>KATHLEEN DC. MELENDREZ</b> PLANNING OFFICER IV	 <b>ENGR. EDUARDO C. VILLALON JR.</b> PLANNING OFFICER V	 <b>CECILLE LORENZANA ROMERO</b> EXECUTIVE DIRECTOR III	CPM (KWEBA)	<b>AR-04</b>
	LOCATION: CENTRAL SECTION, RIZAL PARK, TM KALAW MANILA					

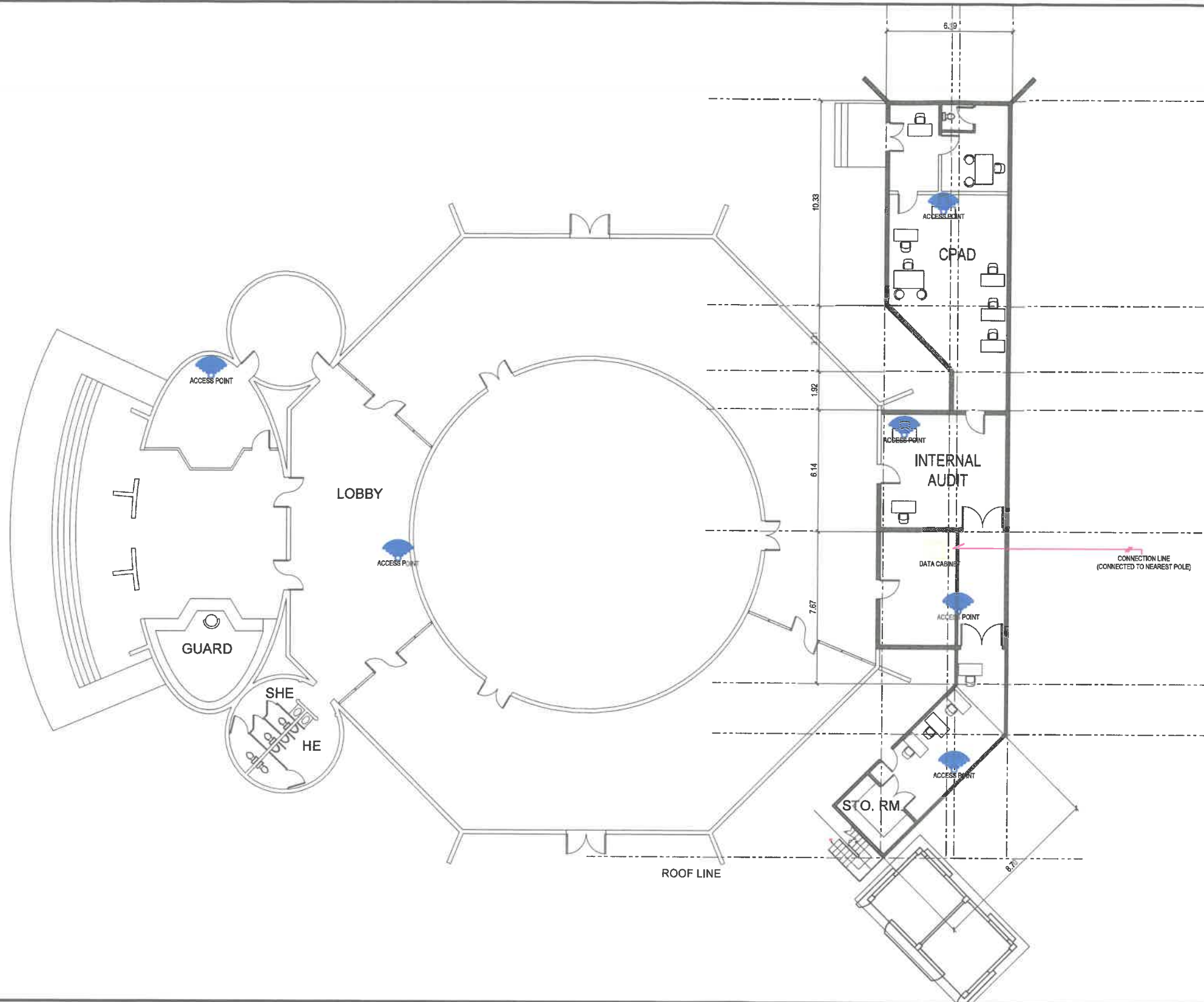

# 1 PLANETARIUM

SCALE: 1:250MTS



**NATIONAL PARKS DEVELOPMENT COMMITTEE**  
TM KALAW MANILA

PROJECT TITLE :  
**INSTALLATION OF FIBER OPTIC IN RIZAL PARK AND PACO PARK PROJECT (AMENDMENT TO ORDER)**

LOCATION: CENTRAL SECTION, RIZAL PARK, TM KALAW MANILA

PREPARED BY:  
**ENGR. LERIZA S. CANALES**  
DRAFTSMAN II

CHECKED BY:  
**KATHLEEN DC. MELENDREZ**  
PLANNING OFFICER IV

RECOMMENDING APPROVAL:  
**ENGR. EDUARDO C. VILLALON JR.**  
PLANNING OFFICER V

APPROVED BY:  
**CECILLE LORENZANA ROMERO**  
EXECUTIVE DIRECTOR III

SHEET CONTENT  
PLANETARIUM

SHEET NO.

**AR-05**